

GSJ ROYALE BLOCK - C



SPECIAL AMENITIES

- Centrally located and very near to important place like Colleges, Hospital, Church, Beach, Market Etc.
- Beautiful Elevation with class I construction under the experienced Technical Team.
- State of the art Facilities
- Beautiful Entrance Lobby .
- Automatic 8 passengers capacity elevator .
- Generator backup for lifts , pumps ,common lights and Lighting points in each apartments.
- Reticulated gas connection for all apartments.
- Terrace covered with sheet roof for small part hall.
- Car parking in stilt floor.
- Intercom Facility.

TECHNICAL SPECIFICATIONS

- RCC Framed structure as per IS-456.
- Laterite Masonry for external walls and solid block for internal wall.
- Cement mortar plastering inside and outside.
- Good quality wooden panel door for entrance and Flush door for all rooms.
- Vitrified Tiles flooring for entire flats.
- Powder coating Aluminium with safe grills.
- ISI branded electrical switches with finolex /RR or any other equivalent make.
- Good quality toilet tiles and sanitary fittings.

SPECIAL FEATURES

- Kitchen : Black Granite platform with steel sink provision for fridge, mixer, grinder oven and chimney points.
- Bed Room : Provision of AC points and Telephone in Master Bedrooms
- Toilet : Glazed ceramic tiles up to 7' 00" in toilets or equivalents make sanitary wares. Branded plated toilet fittings.

Ground Floor

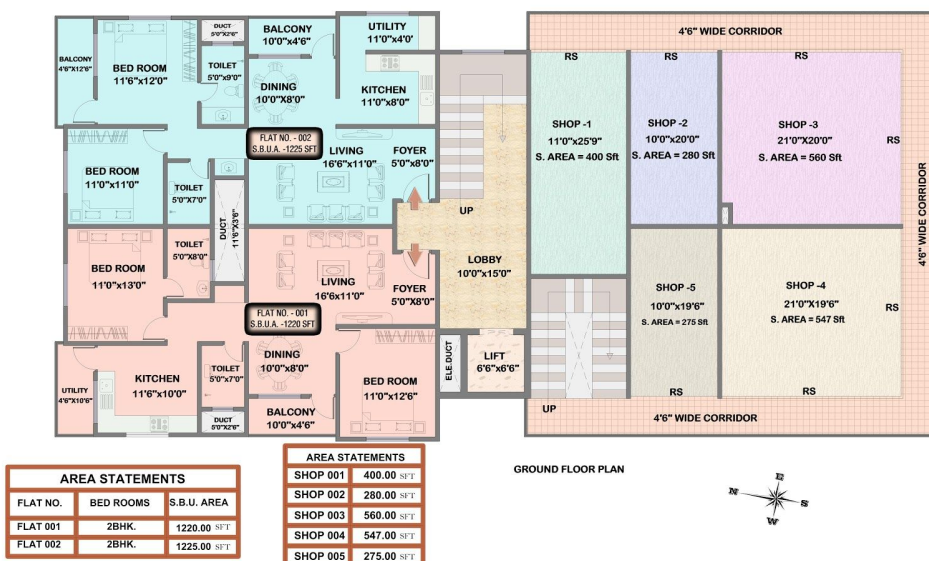

Typical Floor



GSJ Developers

Rosary Queen, Shop No.3, Nejar Kallianpur, Post Santhekatte,

Udupi - 576105

Ph: 0820 - 2583154, Mob: 9480138141, 9880881020